

110-200kg



SSMH/XM SERIES

Housing made of pressed stainless steel (grade 304) with sealed double ball race in swivelhead.

Available with top plate or single bolthole fixing.

SSMH/XM SERIES HIGH TEMP

WHEEL CODE		AN*		TP		RNHT			
Wheel diam (mm)	Swivel or fixed	Tread width (mm)	Overall height (mm)	Plate type	Swivel radius (mm)	Bearing type	300C black phenolic	300C thermoplastic	250C black elastic rubber on phenolic
80	S	35	113	A	80	SSMH80AN3 150kg	-	-	-
						SSMH80AN3TF 150kg	-	-	-
80	F	35	113	A	-	SSMHF80AN3 150kg	-	-	-
						SSMHF80AN3TF 150kg	-	-	-
100	S	30 AN=35	133	A	92	SSMH100AN3 180kg	SSMH100TP3 150kg	SSMH100RNHT 110kg	-
						SSMH100AN3TF 180kg	SSMH100TP3TF 150kg	SSMH100RNHTTF 110kg	-
100	F	30 AN=35	133	A	-	SSMHF100AN3 180kg	SSMHF100TP3 150kg	SSMHF100RNHT 110kg	-
						SSMHF100AN3TF 180kg	SSMHF100TP3TF 150kg	SSMHF100RNHTTF 110kg	-
100	S	30 AN=35	135	B	92	SSMH100AN3LP 180kg	SSMH100TP3LP 150kg	SSMH100RNHTLP 110kg	-
						SSMH100AN3LPTF 180kg	SSMH100TP3LPTF 150kg	SSMH100RNHTLPTF 110kg	-
125	S	40	158	A	107	SSMH125AN3 200kg	-	-	-
125	F		158	A	-	SSMHF125AN3 200kg	-	-	-
125	S		160	B	107	SSMH125AN3LP 200kg	-	-	-

No brakes available on this castor series

100	S	30 AN=35	130	A	92	SSXM100AN3 160kg	SSXM100TP3 150kg	SSXM100RNHT 110kg
						SSXM100AN3TF 160kg	SSXM100TP3TF 150kg	SSXM100RNHTTF 110kg
100	F	30 AN=35	130	A	-	SSXMF100AN3 160kg	SSXMF100TP3 150kg	SSXMF100RNHT 110kg
						SSXMF100AN3TF 160kg	SSXMF100TP3TF 150kg	SSXMF100RNHTTF 110kg

No brakes available on this castor series

* also available to 350°C temperature specification
- details on request

Single bolthole castor (12mm)

add to code: **BH12**

WHEEL BEARING KEY

- Plain bore
- Teflon bush

AVAILABLE WHEEL TYPES (for full wheel specifications refer to pages indicated)



p82

p83

p83

Call Merlin 0845 124 9955

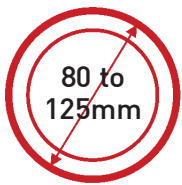

110-200kg

PLATE TYPES AND DIMENSIONS (mm)

Type A

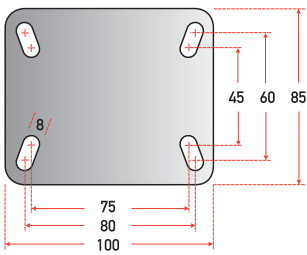

Type B

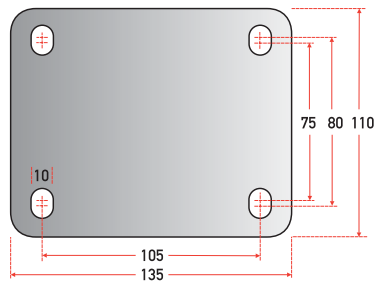

Single bolthole
add to code: BH12

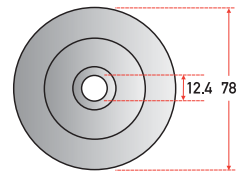

SSMH/XM SERIES HIGH TEMP

Call Merlin 0845 124 9955