

Maximise  
Divide  
Enhance

two

three



The standard modules in three depths and six widths have a fully integrated internal storage and filing system for creating efficient storage solutions.

# FIREWALL

**Available from Merlin Industrial Products - 01752 690622 - [sales@mipl.uk](mailto:sales@mipl.uk)**



Application

Integration  
Dynamic  
Effective



**FREEWALL** offers the unique blend of modular space planning footprints with the flexibility of bespoke frontages, that are tailored to each customer's needs. The units can be designed to fit around elements within the building structure as well as keeping a fluid feel to the working environment. Many different levels of interaction and privacy can be incorporated not only within an office but to an individual wall of cupboards.



Stepped room dividing wall



The simple yet robust construction allows the units to be built quickly whilst offering unrivalled strength, stability and durability. The units are all made to fit exactly at the factory, eliminating time on site as well as minimising disruption, especially where buildings maybe already in occupation.

FREEWALL

Available from Merlin Industrial Products - 01752 690622 - [sales@mipl.uk](mailto:sales@mipl.uk)



Application

Integration  
Dynamic  
Effective

It is paramount that there is an effective appraisal of the immediate and future needs of an organisation's storage requirements. **FREEWALL** can then be integrated into the demands of the workforce and the office environment. An example of this was the demand for more desk space whilst achieving faster access times to the filing. The solution was to use side opening and up and over tambours enabling the footprint in front of the units to be greatly reduced, providing an open face for document retrieval without chance of damage or injury through doors being left open.



Vertical tambours



Side opening tambours

FREEWALL

Available from Merlin Industrial Products - 01752 690622 - sales@mipl.uk



Application



Library storage

**FREEWALL** offers solutions to new working practices in a way no other storage system can. The ability to change and meet these demands is achieved through the flexibility in design, versatility of the materials used and the quality of the fittings and components. This is shown in applications where units need to be capped at any height due to high ceilings or perimeter air conditioning vents. Also, the integration of different ways to access the stored material, such as bookcase sections for referenced material whilst incorporating low level cupboards for personal security.



Bookcase / cupboard storage

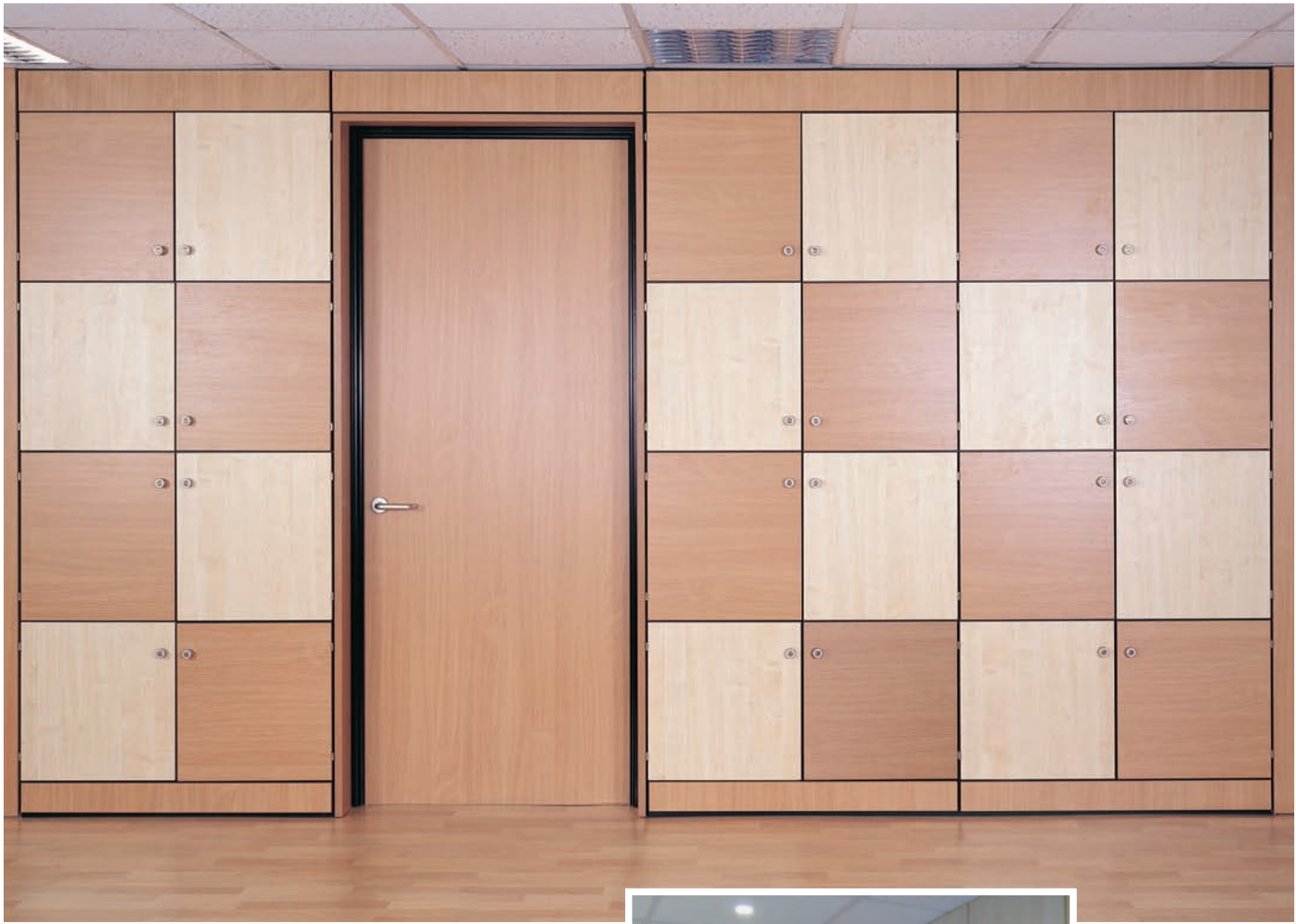

Locker units / pass thru door



Locker units

The dynamic working practices of the modern organisation need flexible solutions. The improvements in technology and the introduction of flexible working, has put new demands on the office of today. **FREEWALL** can provide personnel with docking stations or lockers allowing a transient feel to their workspace. This enables a rationalisation of the number of workstations and resources needed as well as savings in floor space.

Integration  
Dynamic  
Effective



**FREEWALL** gives designers the freedom to create units that reflect the style of the company or environment. This can be achieved through bespoke units, contemporary material choice and fittings. This enables the customer to enhance the workplace and reinforce the company's identity. The realisation of this is shown through a range of visuals from simple line drawings to 3D computer graphics.

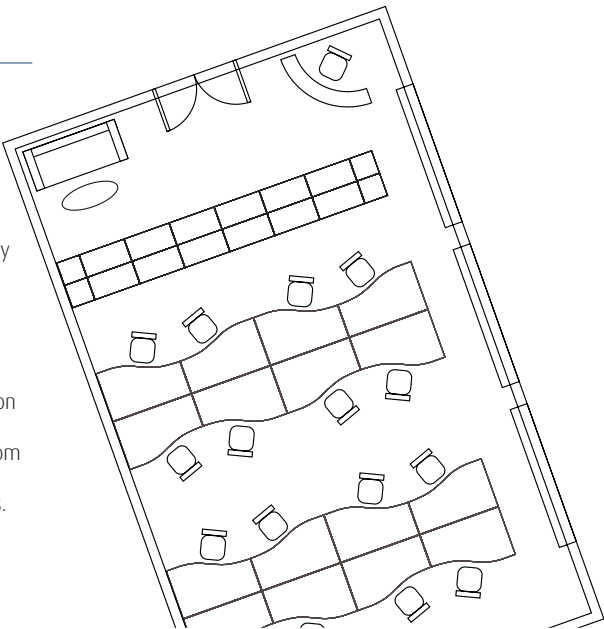

Wide open alcoves



Manifestations to fronts



Glass Doors



**FREEWALL'S** mix of modern manufacturing techniques and new materials has created an endless depth of design opportunities. The ethos of providing efficient storage solutions is not lost, simply enhanced. Wave and curve walls epitomise this trend, reflecting the styles of today's workstations and desks.

The clever contrast of different finishes enhances still further a modern and more fluid feel to any storage area.



 Curved walls



●



•



- Contemporary
- Traditional
- Retrospective

When presented with a problem **FREEWALL** always projects the right image. In the boardroom, **FREEWALL** can harbour a host of facilities for professional presentations. Audio visual technology, plasmas screens, projector screens and video systems, dry wipe boards and flip charts are easily accessed whenever they are needed and swiftly concealed when the client meeting, training session or staff briefing ends. This imaginative and unobtrusive arrangement safeguards expensive equipment, adds security and guarantees that meeting areas remain business like at all times.



Open central AV unit



Garment unit / Storage unit



Modular AV walls

FREEWALL



Quality  
Detail  
Choice

The cupboards can be dismantled and relocated any number of times as all structural fixings are made into threaded inserts.

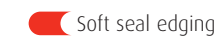
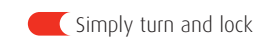
[illegible]





Shaped and bow handles

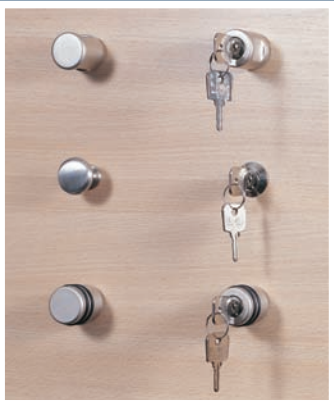

Turn handles and knobs



Bow and t-bar handles

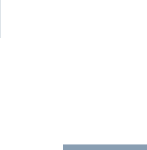
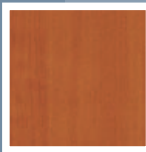

**FREEWALL** offers the widest choice of finishes from any manufacturer. We offer pastel and bold colours as well as a huge choice of modern and traditional wood grains in both melamine and laminate surfaces. We also offer a huge choice of natural real wood veneers along with the ability to stain and tint to meet the customers exact requirements.

**FREEWALL**





Free standing dividers



Garment rails



Anti-tilt filing frame



Drop-in bin



Compartment drawers



CD drawer



Suspended divider

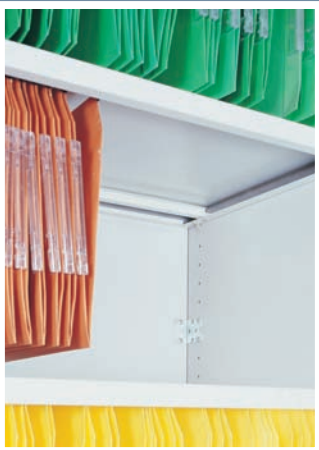

Combination shelf - with adjustable rail



Standard filing frame



Roll out reference shelf



Shallow slotted drawer

**FREEWALL** has the widest range of accessories on the market. We are more than happy to make bespoke internal fittings to suit your requirements.